

# airMAX™

Revolutionary MIMO TDMA Protocol System



## True Carrier Class Network Performance

**Scalability:** 300+ subs per sectored base station

**Latency:** Latency remains low for voice and video applications as network scales

**Speed:** 150Mbps+ PtMP performance

**Range:** 50km+ outdoor range



## World Class BaseStation Antenna Design

Ubiquiti's Antenna R&D team applied their years of experience in cellular basestation antenna design in developing the revolutionary AirMax BaseStation and Rocket Antennas. Exhibiting gain, beam characteristics, and multi-polarity performance never before seen in wireless ISP markets.



2.4GHz 16dBi 90°

2.4GHz 15dBi 120°

5GHz 20dBi 90°

5GHz 19dBi 120°

5GHz 18/17dBi 90/120°

5GHz 30dBi Dish

## Flexible Deployment Options

**Rocket M Series:** Highest performance, 2x2 MIMO AirMax Basestation.

**NanoStation M Series:** Flexible, powerful, cost-effective 2x2 CPE for bridging applications.

**NanoStation Loco M Series:** Low-cost, hi-performance 2x2 CPE available in 5GHz.

**Bullet M Series:** Versatile single antenna AirMax solution for wide application use.



Rocket M Series



NanoStation M Series



NanoStation Loco M Series



Bullet M Series

## Rocket M Seamlessly Integrates with AirMax BaseStation and Rocket Antennas

Rocket M and AirMax BaseStation/Rocket Antennas have been designed to seamlessly work together. Installing Rocket M on AirMax BaseStation/Rocket Antennas requires no special tools, you simply snap it into place with the mount provided with the Antennas.

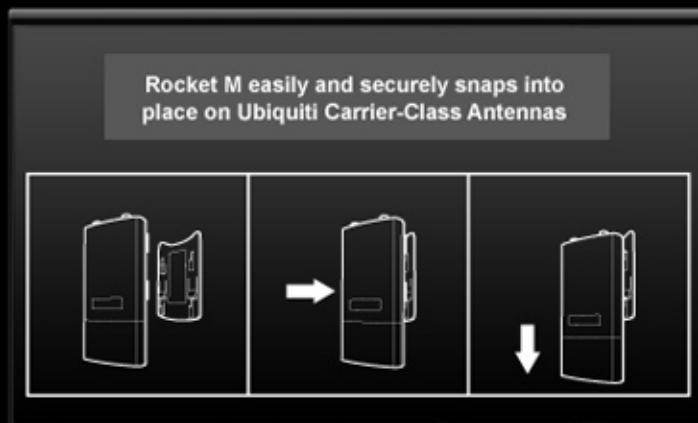

Rocket M easily and securely snaps into place on Ubiquiti Carrier-Class Antennas

